

Melville Corridor

Plan ~ Melville St. Corridor

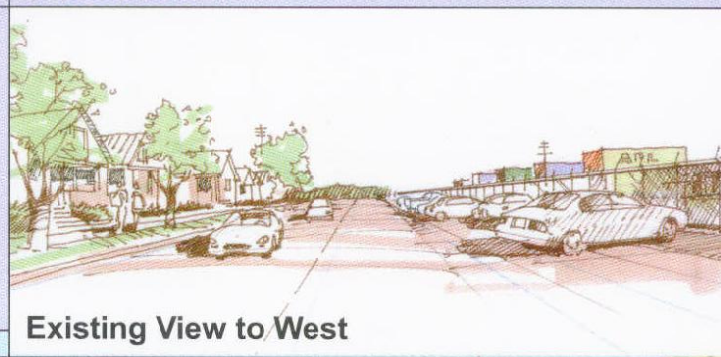

Existing View to West

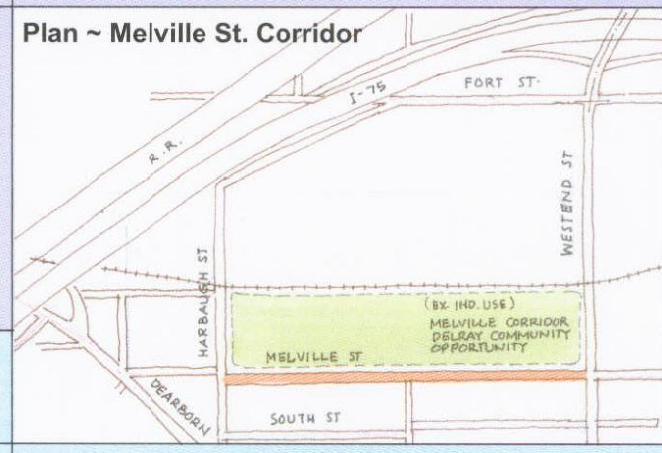

Proposed View ~ Melville Street Corridor

Detroit River International Crossing Study
Preliminary Concepts - Delray
Gateway Boulevard

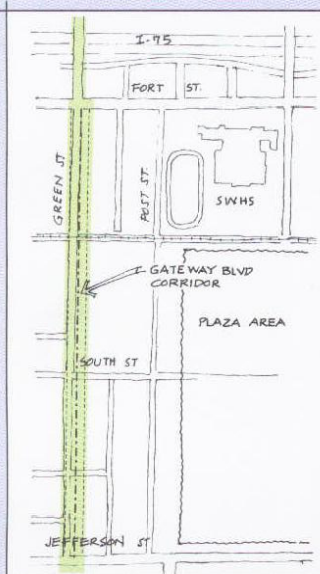

Plan ~ Gateway Blvd. Corridor

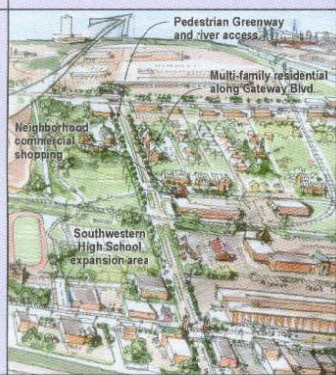

Birdseye ~ Looking South



Proposed Gateway Blvd ~ View Looking South

Fort at Southwestern H.S.



Public Improvements



Private Investment

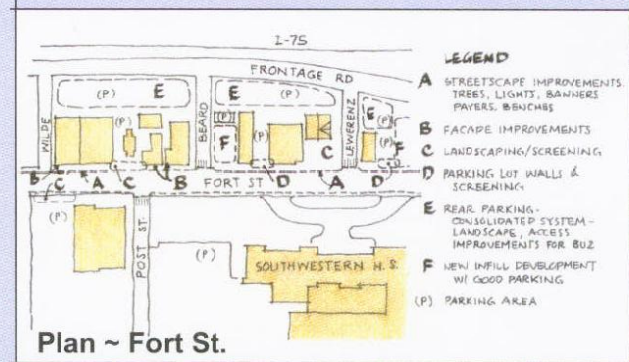

Plan ~ Fort St.



Fort Street at Southwestern H.S. ~ Looking Easterly

Detroit River International Crossing Study
Preliminary Concepts - Delray

Fort at Southwestern H.S.

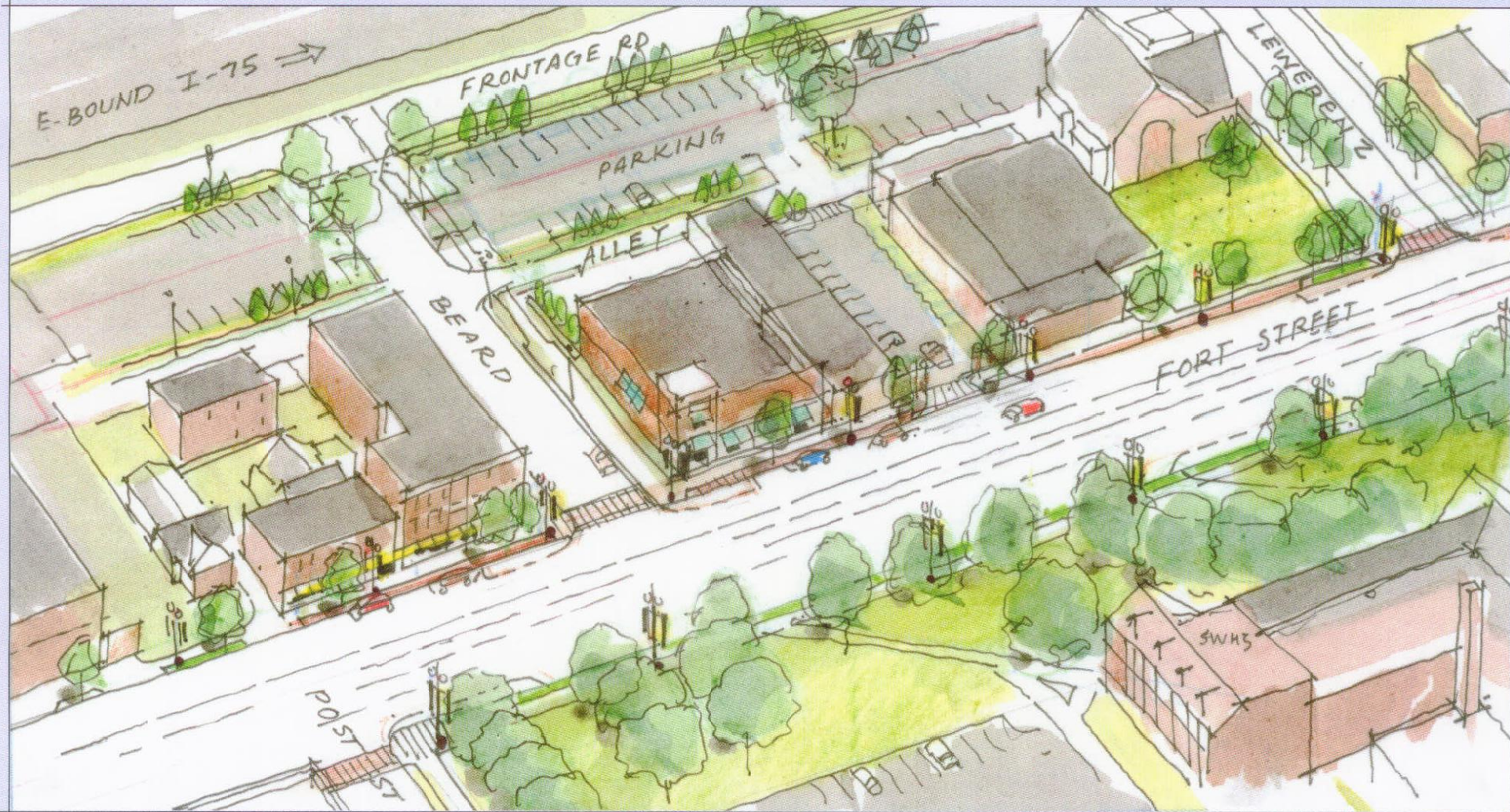

Fort Street at Southwestern High School

Detroit River International Crossing Study
Preliminary Concepts - Delray
Junction Corridor

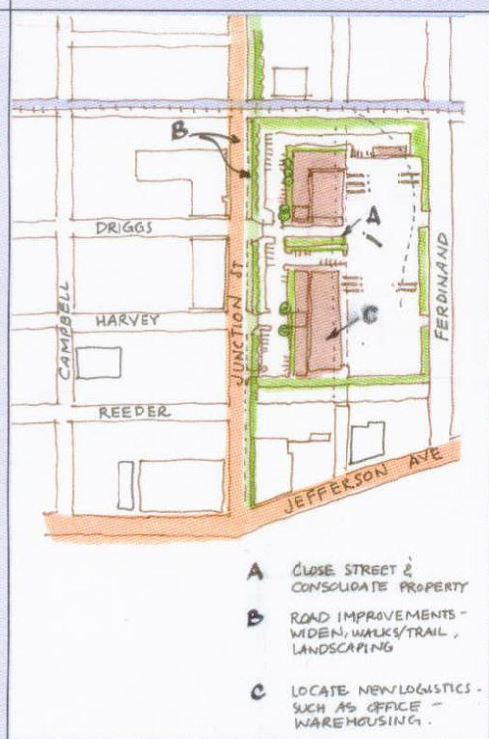

Plan ~ Logistics Development
East Delray - Along Junction St.

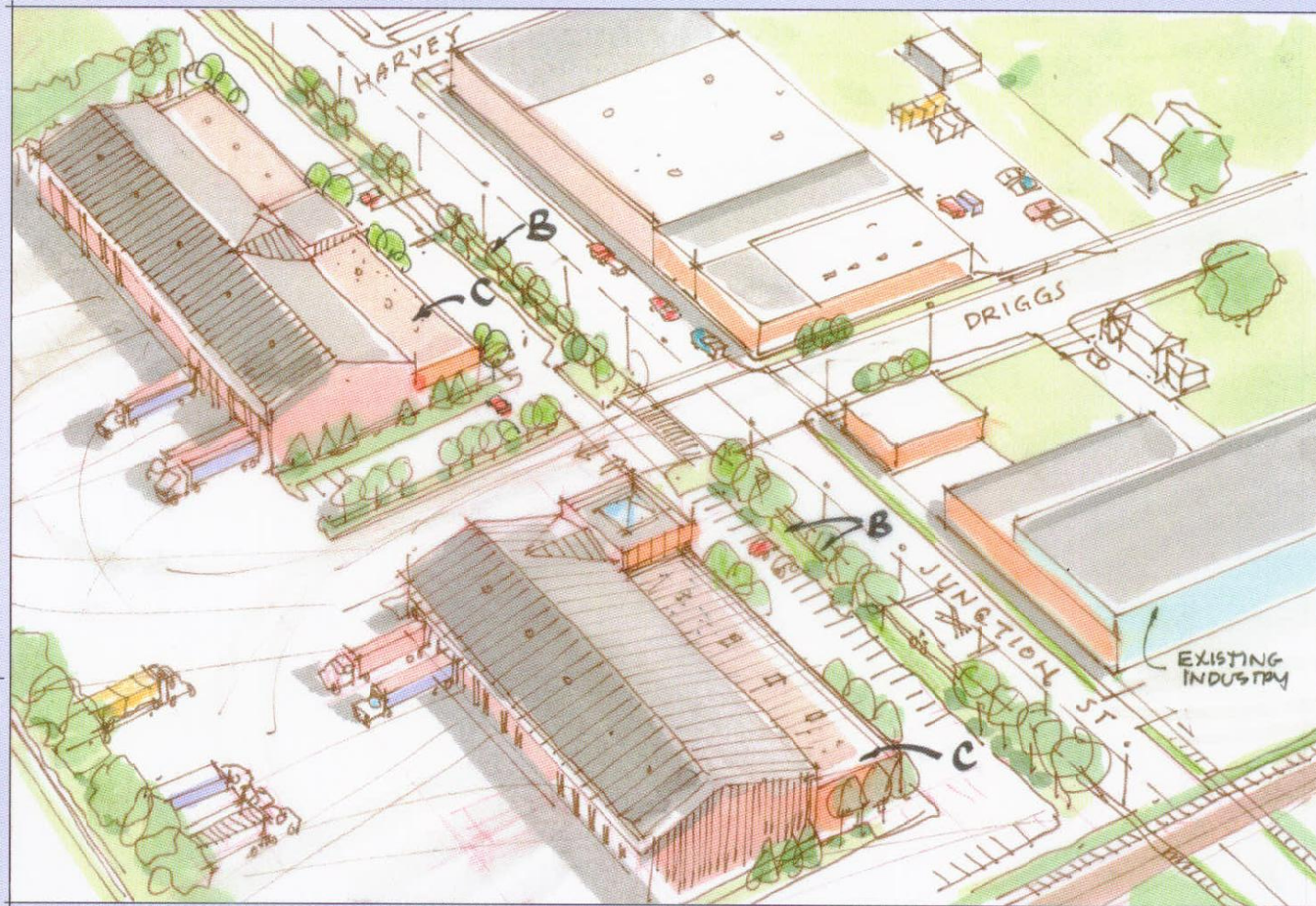

East Delray ~ Logistics Development Along N-S Corridors Such as Junction St.

Detroit River International Crossing Study

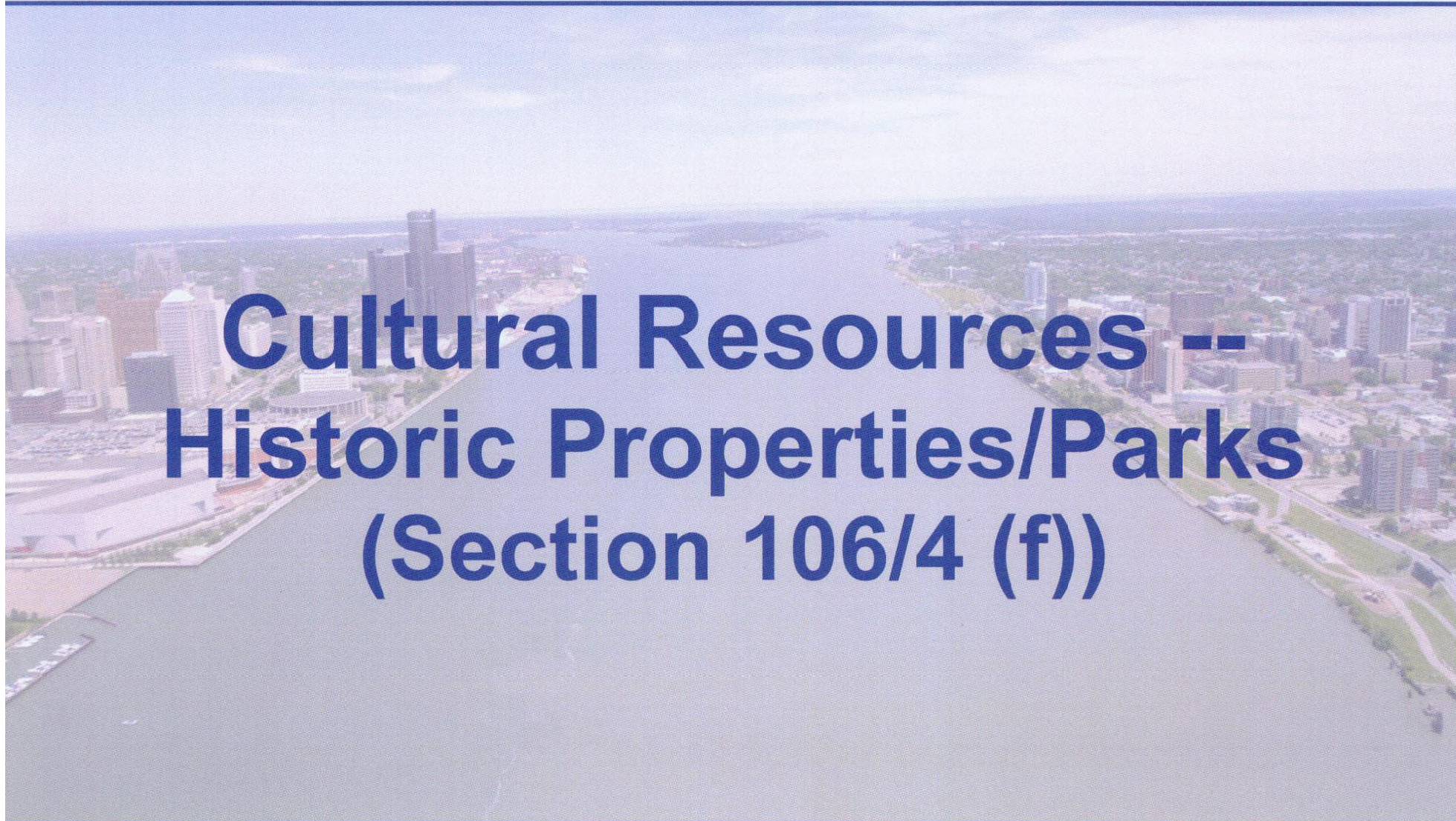

Cultural Resources -- Historic Properties/Parks (Section 106/4 (f))

Aboveground Resources on or Recommended Eligible for Listing in the National Register of Historic Places (NRHP)

Detroit River International Crossing Study

Aboveground Resources on or Recommended Eligible for Listing in the NRHP

1. Fort Wayne
2. Frank Beard School
3. Detroit Copper and Brass Rolling Mills Complex
4. Detroit Union Produce Terminal
5. Michigan Bell Telephone Vinewood Dial Office Building
6. Fort Street/Green Street Detroit Police Station
7. Southwestern High School
8. Olivet Presbyterian/Old Landmark Church of God in Christ
9. Detroit Savings Bank/George International Building
10. Berwalt Manor Apartment Building
11. Roberts Brass Manufacturing Building
12. Mistersky Power Station Complex/Detroit Public Lighting Commission
13. Findlater Masonic Temple/Salon El Bosque
14. St. John Cantius Polish Catholic Church Complex
15. Delray Community Historic District and Holy Cross Hungarian Roman Catholic Church Complex
16. Military Avenue Evangelical Presbyterian Church
17. Kovacs Bar
18. St. Paul African Methodist Episcopal Church
19. Detroit Fire Department Engine Company No. 29
20. Detroit Harbor Terminal Building
21. Motz's Burgers
22. West Lafayette Boulevard Rowhouse Historic District
23. Delray Commercial Historic District
24. Szent Janos Gor Kath. Magyar Templom/Jehovah Jireh

Note: Tier 1 is the maximum direct acquisition area. Tier 2 is immediately adjacent to Tier 1 and takes into consideration possible indirect impacts such as visual and noise impacts. Tier 3 is the West Delray area which may see new development in the future.

Source: Commonwealth Cultural Resources Group, Inc. and The Conadino Group of Michigan, Inc.



LEGEND

APE means Area of Potential Effect and for DRIC consists of three tiers.

- Tier 1
- Tier 2
- Tier 3

Summary of Project Effects on Recommended National Register Eligible Cultural Resources

Detroit River International Crossing Study

Alternative Site ^a	#1	#2	#3	#5	#7	#9	#11	#14	#16
1 Fort Wayne	Adverse visual effect: 0.2 acres from site needed	Adverse visual effect: 0.2 acres from site needed	No effect	Adverse visual effect: 0.1 acres from site needed	Adverse visual effect: 0.2 acres from site needed	Adverse visual effect: 0.2 acres from site needed	No effect	No Effect	Adverse visual effect: Adverse effect: 0.2 acres from site needed
2 Frank Beard School	No Effect	No Effect	No Effect	No Effect	No Effect	No Effect	No Effect	No Effect	No Effect
3 Detroit Copper and Brass Rolling Mills Complex	No adverse effect	No adverse effect	No adverse effect	No adverse effect	No adverse effect	No adverse effect	No adverse effect	No adverse effect	No adverse effect
4 Detroit Union Produce Terminal	No Effect	No Effect	No Effect	No Effect	No Effect	No Effect	No Effect	No Effect	No Effect
5 The Michigan Bell Telephone Viewwood Dial Office Building	No Effect	No Effect	No Effect	No Effect	No Effect	No Effect	No Effect	No Effect	No Effect
6 Fort Street/Green Street Detroit Police Station	No Effect	No Effect	No Effect	No Effect	No Effect	No Effect	No Effect	No Effect	No Effect
7 Southwestern High School	No Effect	No Effect	No Effect	No Effect	No Effect	No Effect	No Effect	No Effect	No Effect
8 Olivet Presbyterian/Old Landmark Church of God In Christ	No adverse effect	No adverse effect	No adverse effect	No adverse effect	No adverse effect	No adverse effect	No adverse effect	No Effect	No adverse effect
9 Detroit Savings Bank/George International Building	No adverse effect	No adverse effect	Adverse visual effect: Adverse effect: removal	Adverse effect: removal	No adverse effect	No adverse effect	Adverse visual effect: Adverse effect: removal	No adverse effect	No adverse effect
10 Berwall Manor Apartment Building	Adverse effect: removal	Adverse effect: removal	Adverse effect: removal	Adverse effect: removal	Adverse effect: removal	Adverse effect: removal	Adverse visual effect: Adverse effect: removal	Adverse effect: removal	Adverse effect: removal
11 Roberts Brass Manufacturing Building	No Effect	No Effect	No Effect	No Effect	No Effect	No Effect	No Effect	No Effect	No Effect
12 Mistersky Power Station Complex/Detroit Public Lighting Commission	No Effect	No Effect	No Effect	No Effect	Adverse visual effect	Adverse visual effect	Adverse visual effect	No Effect	No Effect
13 Findlater Masonic Temple/Salon El Bosque	No Effect	No Effect	No Effect	No Effect	No Effect	No Effect	No Effect	No Effect	No Effect
14 St. John Cantius Polish Catholic Church Complex	No Effect	No Effect	No Effect	No Effect	No Effect	No Effect	No Effect	No Effect	No Effect
15 Delray Community Historic District and Holy Cross Hungarian Roman Catholic Church Complex	No Effect	No Effect	No Effect	No Effect	No Effect	No Effect	No Effect	No Effect	No Effect
16 Military Avenue Evangelical Presbyterian Church	No Effect	No Effect	No Effect	Adverse visual effect	No Effect	No Effect	No Effect	No Effect	No Effect
17 Kovacs Bar	Adverse effect: removal	Adverse effect: removal	Adverse effect: removal	Adverse effect: removal	Adverse effect: removal	Adverse effect: removal	Adverse effect: removal	Adverse effect: removal	Adverse effect: removal
18 St. Paul African Methodist Episcopal Church	Adverse effect: removal	Adverse effect: removal	Adverse effect: removal	Adverse effect: removal	Adverse effect: removal	Adverse effect: removal	Adverse effect: removal	Adverse effect: removal	Adverse effect: removal
19 Detroit Fire Department Engine Company No. 29	No Effect	No Effect	No Effect	No Effect	No Effect	No Effect	No Effect	No Effect	No Effect
20 Detroit Harbor Terminal Building	No Effect	No Effect	No Effect	No Effect	No Effect	No Effect	No Effect	No Effect	No Effect
21 Maz's Burgers	No Effect	No Effect	No Effect	No Effect	No Effect	No Effect	No Effect	No Effect	No Effect
22 West Lafayette Boulevard Rowhouse Historic District	No Effect	No Effect	No Effect	Adverse visual effect	No Effect	No Effect	No Effect	No Effect	No Effect
23 Delray Commercial Historic District	No Effect	No Effect	No Effect	No Effect	No Effect	No Effect	No Effect	No Effect	No Effect
24 Saint Janos Cor Kath. Magyar Templom/Lehorath Jeth	No Effect	No Effect	No Effect	No Effect	No Effect	No Effect	No Effect	No Effect	No Effect
20WM1132	Adverse Effect: Mitigation through archaeological data recovery	Adverse Effect: Mitigation through archaeological data recovery	Adverse Effect: Mitigation through archaeological data recovery	Adverse Effect: Mitigation through archaeological data recovery	Adverse Effect: Mitigation through archaeological data recovery	Adverse Effect: Mitigation through archaeological data recovery	Adverse Effect: Mitigation through archaeological data recovery	Adverse Effect: Mitigation through archaeological data recovery	Adverse Effect: Mitigation through archaeological data recovery
20WM1133	Adverse Effect: Mitigation through archaeological data recovery	Adverse Effect: Mitigation through archaeological data recovery	Adverse Effect: Mitigation through archaeological data recovery	Adverse Effect: Mitigation through archaeological data recovery	Adverse Effect: Mitigation through archaeological data recovery	Adverse Effect: Mitigation through archaeological data recovery	Adverse Effect: Mitigation through archaeological data recovery	Adverse Effect: Mitigation through archaeological data recovery	Adverse Effect: Mitigation through archaeological data recovery

^aRefer to Figure 3-35 for site location.

Sites with shading have an adverse effect.

Sites in red and bold are likely a Section 4(f) use under at least 1 alternative (see Section 5 of this report)

Source: Commonwealth Cultural Resources Group, Inc. and The Corradino Group of Michigan, Inc.

Detroit River International Crossing Study

**Berwalt Manor Apartment Building,
760 South Campbell Street**



**Kovacs Bar,
6982 West Jefferson Avenue**

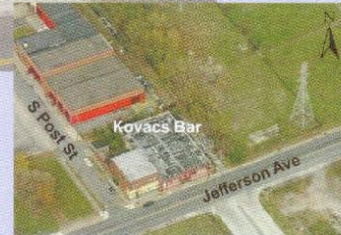

**Detroit Savings Bank/George International
Building, 5705 West fort Street**



**St. Paul African Methodist Episcopal
Church, 579 South Rademacher Street**

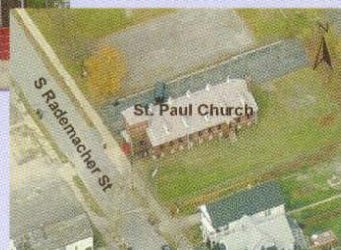
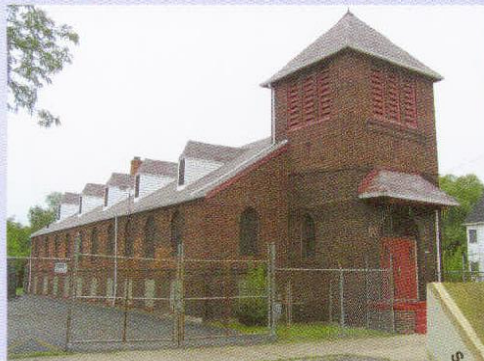

**Frank H. Beard School,
8840 North Waterman Street**

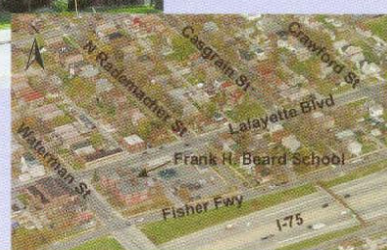

**Rademacher Park and
Recreation Center**



Post-Jefferson Playlot



Photo Simulation Locations Map

